

FIXED CASEWORK

B r o c h u r e



SEFA compliant

Contents



TOPIC

PAGE

BUILT-IN CASEWORK - INTRO	3
CABINET SPECIFICATIONS	4
ORDERING GUIDE	5
BASE CABINETS - STANDING HEIGHT	6
Open Cabinets	6
Door Cabinets	6
Drawer Cabinets	7
Door & Drawer Cabinets	10
Shelves & Pull Out Shelves	14
Corner Cabinets	14
Three Or Five Equal Drawer Cabinets	15
Sink & Fume Hood Cabinets	16
BASE CABINETS - CORROSIVE	17
Corrosives Storage Cabinets	17
CORROSIVE - VENT KIT	18
BASE CABINETS - FLAMMABLES	19
Flammables Storage Cabinets	19
MOBILE CABINETS	21
OVERLAY CABINETS	23
TALL CABINETS	25
WALL CABINETS - 24" HEIGHT	27
WALL CABINETS - 30" HEIGHT	29
WALL CABINETS - 36" HEIGHT	31
WALL CABINETS - 48" HEIGHT	33
FILLER PANELS	35
FINISHES	37
Powder Coated Steel Frames & Fronts	37



Note:

Images in this catalog are for representation only.

For complete product specifications, contact your workbenches.com representative.

Built-In Casework - Intro



The Built-In Casework system is a rugged, permanent storage solution designed for labs, healthcare facilities, educational institutions, and industrial workspaces. Constructed from folded steel, it delivers long-term durability and efficiency while maintaining a clean, organized workspace.

With a rigid steel chassis and removable back and bottom panels, this system ensures easy maintenance and adaptability without sacrificing strength. Available in multiple configurations, it's built to handle the demands of high-performance environments while providing stable, efficient storage for tools, equipment, and supplies.

Quick Facts

- Versatile and Configurable - Adapts to labs, healthcare, education, and industrial spaces.
- Durable and Low-Maintenance – Rigid steel chassis, with removable panels for easy upkeep.
- High-Performance Storage - Stable, efficient, organization for tools and equipment.
- Made in the USA – Built for superior strength and longevity.



Cabinet Specifications

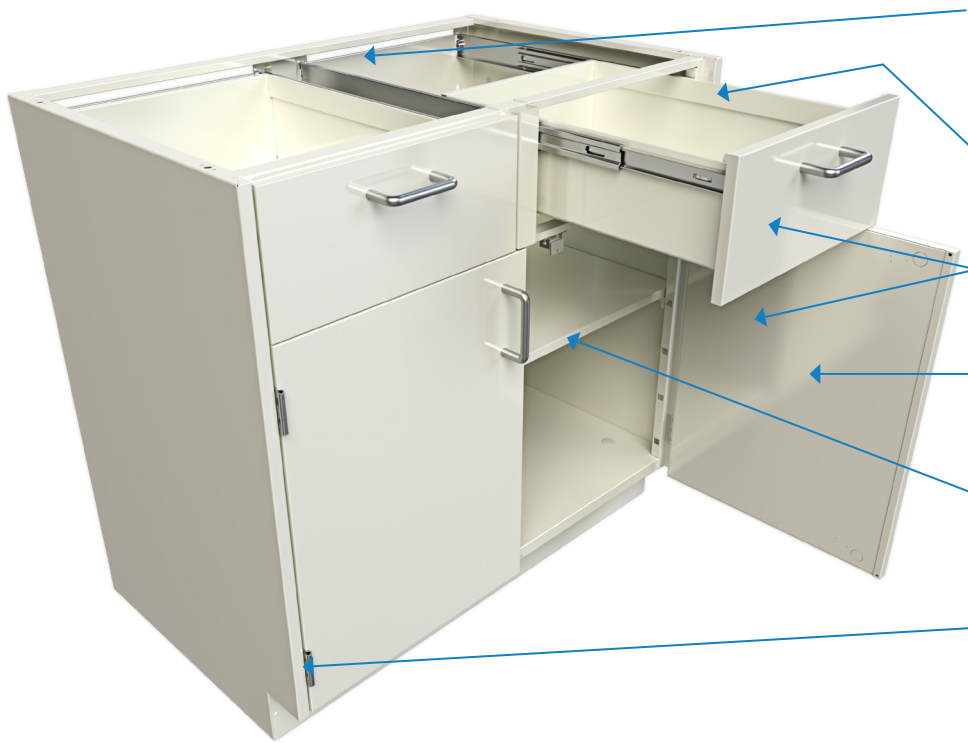

Removable backs

Full extension, ball bearing, plated drawer slides

Doors and drawer heads are “double pan” construction and sound deadened

Adjustable doors with full access opening

Full depth adjustable shelf
Adjustable on 2" centers

Stainless steel, 5 knuckle institutional type hinge — 13 ga.

All surfaces shall be painted or zinc plated. The paint is chemical and UV resistant baked on epoxy-hybrid powder. Specific test data is available upon request.

Gauges of base cabinet components

- Aprons 18 ga.
- Back Panels 18 ga.
- Bottom Panels 18 ga.
- Drawer/Door Outer Panel 20 ga.
- Door Inner Panel 20 ga.
- Drawer Bodies 20 ga.
- Legs - 2"sq. tube 16 ga.
- Shelves 18 ga. 18 ga.
- Side Panels 18 ga.
- Table Frames 18 ga.
- Security Panels 20 ga.

For complete specifications, request our full line of product specifications. Subject to change.

Important Note:

All part numbers may not reflect actual dimensions.

Ordering Guide



S		TYPE	HEIGHT	WIDTH	STYLE	OPTIONS
Cabinet Type						
B	Base (Inset)					
F	Floor (Tall)					
HB	Suspended Base					
OB	Overlay Base					
MB	Mobile Base					
W	Wall					
ASB	Acid Storage Base					
FSB	Flammable Storage					
Base Cabinet Height						
29"	Sitting Height					
32"	ADA Height					
35"	Standing Height					
Wall Cabinet Height						
24" 30" 36" 48"						
Cabinet Width						
12" 15" 18" 21" 24" 30" 36" 42" 48"						
Cabinet Style						
Reference workbenches.com catalog for door and drawer configurations						
Option Suffix (for base cabinet)						
-19	Depth (NPS)			-PS	1 Pull Out Shelf (NPS)	
-LK	Locks			-2PS	2 Pull Out Shelves (NPS)	
-LTK	Toe Kick On Left Side Of Cabinet (NPS)			-3PS	3 Pull Out Shelves (NPS)	
-RTK	Toe Kick On Right Side Of Cabinet (NPS)			-VK	Vent Kit (only for acid cabinet)	
-SS	Stainless Steel, Type 304			-VD	Vertical Divider (NPS)	
-SS316	Stainless Steel, Type 316 (NPS)			-FB	Finished Backs	
-BB	Bread Board(selected models only) (NPS)			-EC	End Covers	
				-F	Flush Pull	
Option Suffix (for wall cabinet)						
-16	16" Depth			-TG	Tempered Glass	
-LK	Locks			-LG	Laminate (Safety) Glass	
-SS	Stainless Steel, Type 304			-THB	Titan Hanging Bracket	
-SS316	Stainless Steel, Type 316			-F	Flush Pull	
Option Suffix (for mobile cabinet)						
-19	Depth (NPS)			-T	3/4" THK. Metal Top	
-LK	Locks			-E	3/4" THK. Epoxy Top	
-SS	Stainless Steel, Type 304			-P	3/4" THK. Phenolic Top	
-SS316	Stainless Steel, Type 316 (NPS)			-2"	Casters (in lieu of standard 3")	
-BB	Bread Board (NPS)			-F	Flush Pull	
Option Suffix (for tall cabinet)						
-LK	Locks			-LG	Laminate (Safety) Glass	
-SS	Stainless Steel, Type 304			-WB	Wardrobe Bracket	
-SS316	Stainless Steel, Type 316 (NPS)			-PS	1 Pull Out Shelves (NPS)	
-TG	Tempered Glass			-F	Flush Pull	

*NPS = Non-Standard Product

Base Cabinets - Standing Height

Standing height base cabinets are 34.75" high and 23.00" deep. Units are available in various widths as shown. Door units feature a single shelf as standard. All open units have 2 shelves. Additional shelves are available. Specify left- or right-hinged doors using the suffix "L" or "R". If locks are required use the suffix "LK". If a finished back is required use the suffix "FB".

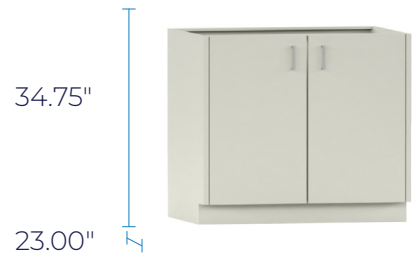

Open Cabinets



Width	Item Number
12"	SB3512-000
15"	SB3515-000
18"	SB3518-000
21"	SB3521-000
24"	SB3524-000

Up to 24" wide



Width	Item Number
30"	SB3530-000
36"	SB3536-000
42"	SB3542-000
48"	SB3548-000

30" and wider

Door Cabinets



Example:
SB3515-100R

Width	Left & Right Hinged
12"	SB3512-100L
15"	SB3515-100L
18"	SB3518-100L
21"	SB3521-100L
24"	SB3524-100L
12"	SB3512-100R
15"	SB3515-100R
18"	SB3518-100R
21"	SB3521-100R
24"	SB3524-100R

Note: L(left) or R(right) refers to door hinge side.



30" and wider

Width	Item Number
30"	SB3530-200
36"	SB3536-200
42"	SB3542-200
48"	SB3548-200

Example: SB3530-100-LHDRPN

Width	Left & Right Hinged
30"	SB3530-100-LPNL
36"	SB3536-100-LPNL
42"	SB3542-100-LPNL
48"	SB3548-100-LPNL
30"	SB3530-100-RPNL
36"	SB3536-100-RPNL
42"	SB3542-100-RPNL
48"	SB3548-100-RPNL



Example: SB3530-100-RHDRPN

Note: L(left) or R(right) refers to door hinge side. PNL(panel) refers to panel next to door

Base Cabinets - Standing Height



Example:

Height Doors Half Drawers
SB3542-034-LK — Lock
 Width Drawers

34.75"

23.00"



Drawer Cabinets



Width	Item Number
12"	SB3512-032
15"	SB3515-032
18"	SB3518-032
21"	SB3521-032
24"	SB3524-032

Up to 24" wide



Width	Item Number
30"	SB3530-032
36"	SB3536-032
42"	SB3542-032
48"	SB3548-032

30" and wider



Width	Item Number
12"	SB3512-024
15"	SB3515-024
18"	SB3518-024
21"	SB3521-024
24"	SB3524-024

Up to 24" wide



Width	Item Number
30"	SB3530-028
36"	SB3536-028
42"	SB3542-028
48"	SB3548-028

30" and wider



Width	Item Number
12"	SB3512-008
15"	SB3515-008
18"	SB3518-008
21"	SB3521-008
24"	SB3524-008

Up to 24" wide



Width	Item Number
30"	SB3530-008
36"	SB3536-008
42"	SB3542-008
48"	SB3548-008

30" and wider



Width	Item Number
12"	SB3512-040
15"	SB3515-040
18"	SB3518-040
21"	SB3521-040
24"	SB3524-040

Up to 24" wide



Width	Item Number
30"	SB3530-040
36"	SB3536-040
42"	SB3542-040
48"	SB3548-040

30" and wider

Base Cabinets - Standing Height

Example:

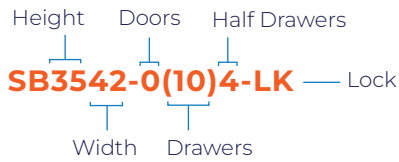

Example:

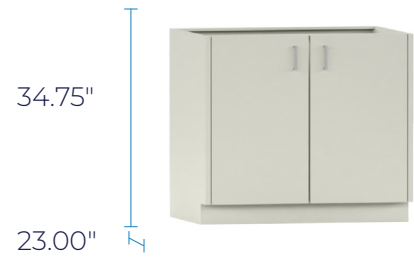
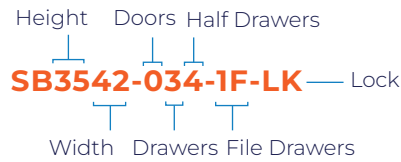

Drawer Cabinets



Width	Item Number
12"	SB3512-012-1F*
15"	SB3515-012-1F*
18"	SB3518-012-1F
21"	SB3521-012-1F
24"	SB3524-012-1F

Up to 24" wide



Width	Item Number
30"	SB3530-024-2F*
36"	SB3536-024-2F
42"	SB3542-024-2F
48"	SB3548-024-2F

30" and wider



Width	Item Number
12"	SB3512-000-2F*
15"	SB3515-000-2F*
18"	SB3518-000-2F
21"	SB3521-000-2F
24"	SB3524-000-2F

Up to 24" wide



Width	Item Number
30"	SB3530-000-4F*
36"	SB3536-000-4F
42"	SB3542-000-4F
48"	SB3548-000-4F

30" and wider



Width	Item Number
12"	SB3512-004-1F*
15"	SB3515-004-1F*
18"	SB3518-004-1F
21"	SB3521-004-1F
24"	SB3524-004-1F

Up to 24" wide



Width	Item Number
30"	SB3530-008-2F*
36"	SB3536-008-2F
42"	SB3542-008-2F
48"	SB3548-008-2F

30" and wider



Width	Item Number
12"	SB3512-020-1F*
15"	SB3515-020-1F*
18"	SB3518-020-1F
21"	SB3521-020-1F
24"	SB3524-020-1F

Up to 24" wide



Width	Item Number
30"	SB3530-040-2F*
36"	SB3536-040-2F
42"	SB3542-040-2F
48"	SB3548-040-2F

30" and wider

*No file rails provided on these sizes

Base Cabinets - Standing Height



Example:



34.75"

23.00"



Drawer Cabinets



30" and wider

Width	Item Number
30"	SB3530-050
36"	SB3536-050
42"	SB3542-050
48"	SB3548-050



30" and wider

Width	Item Number
30"	SB3530-064
36"	SB3536-064
42"	SB3542-064
48"	SB3548-064



30" and wider

Width	Item Number
30"	SB3530-060
36"	SB3536-060
42"	SB3542-060
48"	SB3548-060



30" and wider

Width	Item Number
30"	SB3530-070
36"	SB3536-070
42"	SB3542-070
48"	SB3548-070



30" and wider

Width	Item Number
30"	SB3530-080
36"	SB3536-080
42"	SB3542-080
48"	SB3548-080



30" and wider

Width	Item Number
30"	SB3530-052
36"	SB3536-052
42"	SB3542-052
48"	SB3548-052



30" and wider

Width	Item Number
30"	SB3530-044
36"	SB3536-044
42"	SB3542-044
48"	SB3548-044



30" and wider

Width	Item Number
30"	SB3530-034
36"	SB3536-034
42"	SB3542-034
48"	SB3548-034

Base Cabinets - Standing Height

Example:

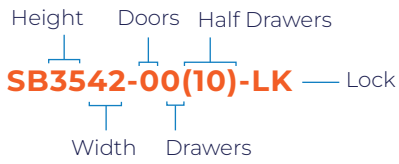

Example:

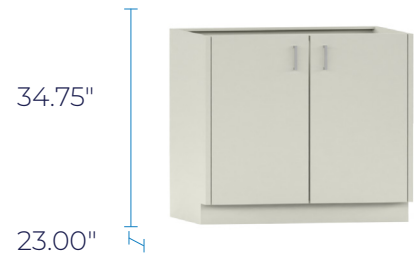
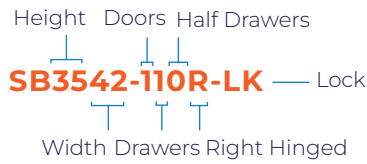

Drawer Cabinets



Width	Item Number
12"	SB3512-016
15"	SB3515-016
18"	SB3518-016
21"	SB3521-016
24"	SB3524-016

Up to 24" wide



Width	Item Number
30"	SB3530-016
36"	SB3536-016
42"	SB3542-016
48"	SB3548-016

30" and wider



Width	Item Number
30"	SB3530-00(16)
36"	SB3536-00(16)
42"	SB3542-00(16)
48"	SB3548-00(16)

30" and wider

Door & Drawer Cabinets



Right-hinged door shown

Width	Left & Right Hinged
12"	SB3512-110L
15"	SB3515-110L
18"	SB3518-110L
21"	SB3521-110L
24"	SB3524-110L
12"	SB3512-110R
15"	SB3515-110R
18"	SB3518-110R
21"	SB3521-110R
24"	SB3524-110R



Right-hinged door shown

Width	Left & Right Hinged
12"	SB3512-102L
15"	SB3515-102L
18"	SB3518-102L
21"	SB3521-102L
24"	SB3524-102L
12"	SB3512-102R
15"	SB3515-102R
18"	SB3518-102R
21"	SB3521-102R
24"	SB3524-102R

Base Cabinets - Standing Height



Example:



34.75"

23.00"



Door & Drawer Cabinets



30" and wider

Width	Item Number
30"	SB3530-212
36"	SB3536-212
42"	SB3542-212
48"	SB3548-212



30" and wider

Width	Item Number
30"	SB3530-220
36"	SB3536-220
42"	SB3542-220
48"	SB3548-220



30" and wider

Width	Item Number
30"	SB3530-202-A
36"	SB3536-202-A
42"	SB3542-202-A
48"	SB3548-202-A



Right-hinged door shown

Width	Left & Right Hinged
30"	SB3530-202L
36"	SB3536-202L
42"	SB3542-202L
48"	SB3548-202L
30"	SB3530-202R
36"	SB3536-202R
42"	SB3542-202R
48"	SB3548-202R



30" and wider

Width	Item Number
30"	SB3530-204
36"	SB3536-204
42"	SB3542-204
48"	SB3548-204



Right-hinged door shown

Width	Left & Right Hinged
30"	SB3530-142L
36"	SB3536-142L
42"	SB3542-142L
48"	SB3548-142L
30"	SB3530-142R
36"	SB3536-142R
42"	SB3542-142R
48"	SB3548-142R



Right-hinged door shown

Width	Left & Right Hinged
30"	SB3530-118L
36"	SB3536-118L
42"	SB3542-118L
48"	SB3548-118L
30"	SB3530-118R
36"	SB3536-118R
42"	SB3542-118R
48"	SB3548-118R



Right-hinged door shown

Width	Left & Right Hinged
30"	SB3530-118-AL
36"	SB3536-118-AL
42"	SB3542-118-AL
48"	SB3548-118-AL
30"	SB3530-118-AR
36"	SB3536-118-AR
42"	SB3542-118-AR
48"	SB3548-118-AR

Base Cabinets - Standing Height

Example:

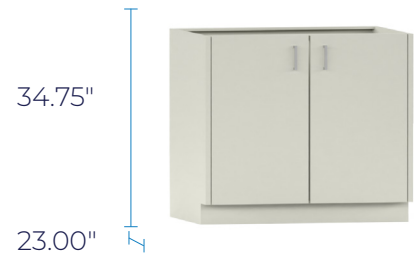
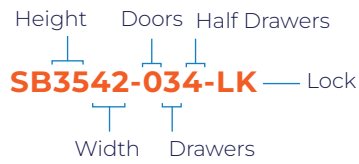

Door & Drawer Cabinets



Right-hinged door shown

Width	Left & Right Hinged
30"	SB3530-140L
36"	SB3536-140L
42"	SB3542-140L
48"	SB3548-140L
30"	SB3530-140R
36"	SB3536-140R
42"	SB3542-140R
48"	SB3548-140R



Right-hinged door shown

Width	Left & Right Hinged
30"	SB3530-140-BL
36"	SB3536-140-BL
42"	SB3542-140-BL
48"	SB3548-140-BL
30"	SB3530-140-BR
36"	SB3536-140-BR
42"	SB3542-140-BR
48"	SB3548-140-BR



Right-hinged door shown

Width	Left & Right Hinged
30"	SB3530-134L
36"	SB3536-134L
42"	SB3542-134L
48"	SB3548-134L
30"	SB3530-134R
36"	SB3536-134R
42"	SB3542-134R
48"	SB3548-134R



Right-hinged door shown

Width	Left & Right Hinged
30"	SB3530-134-AL
36"	SB3536-134-AL
42"	SB3542-134-AL
48"	SB3548-134-AL
30"	SB3530-134-AR
36"	SB3536-134-AR
42"	SB3542-134-AR
48"	SB3548-134-AR



30" and wider

Width	Item Number
30"	SB3530-210
36"	SB3536-210
42"	SB3542-210
48"	SB3548-210



Right-hinged door shown

Width	Left & Right Hinged
30"	SB3530-210-AL
36"	SB3536-210-AL
42"	SB3542-210-AL
48"	SB3548-210-AL
30"	SB3530-210-AR
36"	SB3536-210-AR
42"	SB3542-210-AR
48"	SB3548-210-AR

Base Cabinets - Standing Height



Door & Drawer Cabinets



Right-hinged door shown

Width	Left & Right Hinged
30"	SB3530-150L
36"	SB3536-150L
42"	SB3542-150L
48"	SB3548-150L
30"	SB3530-150R
36"	SB3536-150R
42"	SB3542-150R
48"	SB3548-150R

34.75"

23.00"



Right-hinged door shown

Width	Left & Right Hinged
30"	SB3530-126L
36"	SB3536-126L
42"	SB3542-126L
48"	SB3548-126L
30"	SB3530-126R
36"	SB3536-126R
42"	SB3542-126R
48"	SB3548-126R



Right-hinged door shown

Width	Left & Right Hinged
30"	SB3530-116L
36"	SB3536-116L
42"	SB3542-116L
48"	SB3548-116L
30"	SB3530-116R
36"	SB3536-116R
42"	SB3542-116R
48"	SB3548-116R



Right-hinged door shown

Width	Left & Right Hinged
30"	SB3530-108L
36"	SB3536-108L
42"	SB3542-108L
48"	SB3548-108L
30"	SB3530-108R
36"	SB3536-108R
42"	SB3542-108R
48"	SB3548-108R



Right-hinged door shown

Width	Left & Right Hinged
30"	SB3530-126-AL
36"	SB3536-126-AL
42"	SB3542-126-AL
48"	SB3548-126-AL
30"	SB3530-126-AR
36"	SB3536-126-AR
42"	SB3542-126-AR
48"	SB3548-126-AR



Right-hinged door shown

Width	Left & Right Hinged
30"	SB3530-132L
36"	SB3536-132L
42"	SB3542-132L
48"	SB3548-132L
30"	SB3530-132R
36"	SB3536-132R
42"	SB3542-132R
48"	SB3548-132R



Base Cabinets - Standing Height

Example:

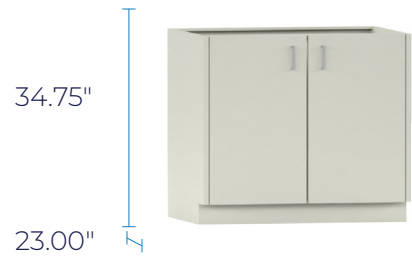
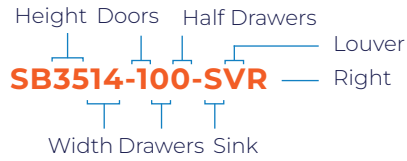

Shelves & Pull Out Shelves

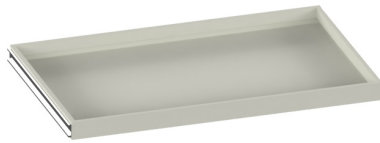
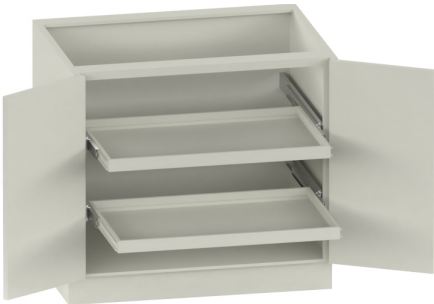
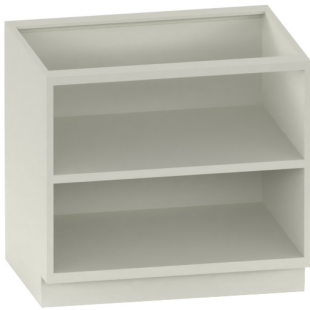

Width	Item Number	Actual Width
12"	SBS1222	11 3/4"
15"	SBS1522	14 3/4"
18"	SBS1822	17 3/4"
21"	SBS2122	20 3/4"
24"	SBS2422	23 3/4"
30"	SBS3022	29 3/4"
36"	SBS3622	35 3/4"
42"	SBS4222	41 3/4"
48"	SBS4822	47 3/4"

Width	Item Number	Actual Width
15"	SBPOS-1522	11 7/8"
18"	SBPOS-1822	14 7/8"
21"	SBPOS-2122	17 7/8"
24"	SBPOS-2422	20 7/8"
30"	SBPOS-3022	26 7/8"
36"	SBPOS-3622	32 7/8"
42"	SBPOS-4222	38 7/8"
48"	SBPOS-4822	44 7/8"

Corner Cabinets



Right-hinged door shown



Right-hinged door shown

Left Hinged	Right Hinged
SC3514-100L	SC3514-100R

Lazy Susan Add-On Suffix "LS"

Left Hinged	Right Hinged
SC3514-100-SL	SC3514-100-SR

Left Hinged with Louvers	Right Hinged with Louvers
SC3514-100-SVL	SC3514-100-SVR

Lazy Susan Add-On Suffix "LS"

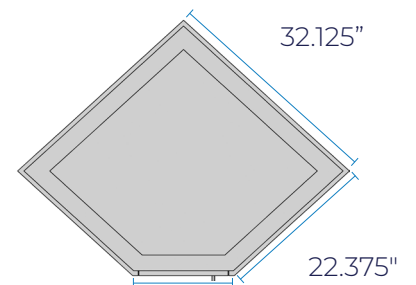

14"

Base Cabinets - Standing Height



Three Or Five Equal Drawer Cabinets



Width	Item Number
12"	SB3512-03X
15"	SB3515-03X
18"	SB3518-03X
21"	SB3521-03X
24"	SB3524-03X



Up to 24" wide



Width	Item Number
12"	SB3512-05X
15"	SB3515-05X
18"	SB3518-05X
21"	SB3521-05X
24"	SB3524-05X



Width	Item Number
30"	SB3530-03X
36"	SB3536-03X
42"	SB3542-03X
48"	SB3548-03X

Up to 24" wide

30" and wider



Width	Item Number
30"	SB3530-05X
36"	SB3536-05X
42"	SB3542-05X
48"	SB3548-05X

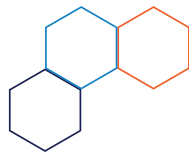

30" and wider



Width	Item Number
30"	SB3530-0(10)X
36"	SB3536-0(10)X
42"	SB3542-0(10)X
48"	SB3548-0(10)X

30" and wider



Width	Left & Right Hinged
30"	SB3530-15X-L
36"	SB3536-15X-L
42"	SB3542-15X-L
48"	SB3548-15X-L
30"	SB3530-15X-R
36"	SB3536-15X-R
42"	SB3542-15X-R
48"	SB3548-15X-R

Right-hinged door shown



Base Cabinets - Standing Height

Example:

Height Doors Half Drawers
SB3552-200-SI — Island
 Width Drawers Sink

34.75"

23.00"



Sink & Fume Hood Cabinets



Right-hinged door shown

Add "-SV(R/L)" for Vents

Width	Left & Right Hinged
12"	SB3512-100-SL
15"	SB3515-100-SL
18"	SB3518-100-SL
21"	SB3521-100-SL
24"	SB3524-100-SL
12"	SB3512-100-SR
15"	SB3515-100-SR
18"	SB3518-100-SR
21"	SB3521-100-SR
24"	SB3524-100-SR



30" and wider

Width	Item Number
30"	SB3530-200-S
36"	SB3536-200-S
42"	SB3542-200-S
48"	SB3548-200-S

Add "-SV" for Vents



Right-hinged door shown

-FHD "Full Height Doors"

Width	Left & Right Hinged
12"	SB3512-100-SL-FHD
15"	SB3515-100-SL-FHD
18"	SB3518-100-SL-FHD
21"	SB3521-100-SL-FHD
24"	SB3524-100-SL-FHD
12"	SB3512-100-SR-FHD
15"	SB3515-100-SR-FHD
18"	SB3518-100-SR-FHD
21"	SB3521-100-SR-FHD
24"	SB3524-100-SR-FHD



30" and wider

Width	Item Number
30"	SB3530-200-S-FHD
36"	SB3536-200-S-FHD
42"	SB3542-200-S-FHD
48"	SB3548-200-S-FHD

-FHD "Full Height Doors"



Width	Item Number
52"	SB3552-200-S
58"	SB3558-200-S

Available with vents:
*Change to -SV

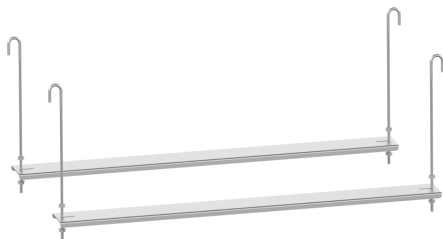

Sink Support Assembly

Item Number
SSS-C14
SSS-18
SSS-24
SSS-30
SSS-36
SSS-42
SSS-48
SSS-52
SSS-58



Width	Item Number
52"	SB3552-200-SI
58"	SB3558-200-SI

Base Cabinets - Corrosive



Corrosives storage cabinets are reinforced steel with a hi-tech performance polymer alloy coating, which provides 100% coverage against corrosion. Cabinets are available in 18" and 22" depths.

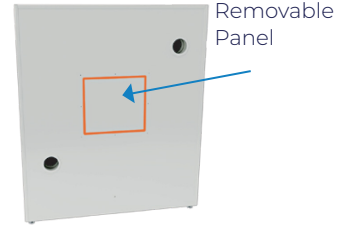

Corrosives Storage Cabinets

24" Wide (1 DOOR)

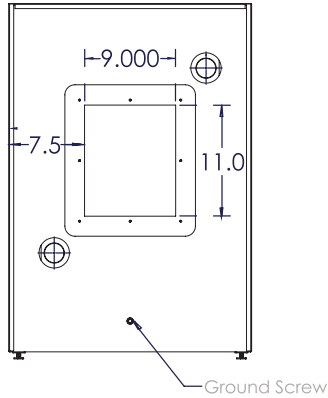

30" Wide (2 DOOR)

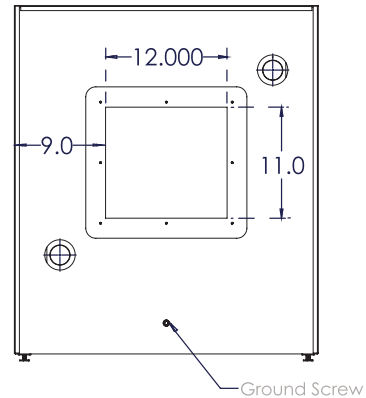

SASBM2930-22

For more information regarding our Oxidizer cabinets, please contact your workbenches.com representative.

Mobile cabinets are available. Please contact your workbenches.com representative.

Width	Sitting Height	ADA Height	Standing Height
18"	SASBM2918-18	SASBM3218-18	SASBM3518-18
24"	SASBM2924-18	SASBM3224-18	SASBM3524-18
30"	SASBM2930-18	SASBM3230-18	SASBM3530-18
36"	SASBM2936-18	SASBM3236-18	SASBM3536-18
42"	SASBM2942-18	SASBM3242-18	SASBM3542-18
48"	SASBM2948-18	SASBM3248-18	SASBM3548-18

Width	Sitting Height	ADA Height	Standing Height
18"	SASBM2918-22	SASBM3218-22	SASBM3518-22
24"	SASBM2924-22	SASBM3224-22	SASBM3524-22
30"	SASBM2930-22	SASBM3230-22	SASBM3530-22
36"	SASBM2936-22	SASBM3236-22	SASBM3536-22
42"	SASBM2942-22	SASBM3242-22	SASBM3542-22
48"	SASBM2948-22	SASBM3248-22	SASBM3548-22

When ordering 18" or 24" wide cabinets please place suffix "L" left or "R" right, after the part number for the hinge placement.

If a Vent Kit is required, use the suffix "VK".

Note: workbenches.com recommends vent kits for all corrosives cabinets. Acids and bases should not be stored in the same cabinet.

Corrosive - Vent Kit

Vent systems shall be manufactured from polyolefin resin and shall conform to ASTM #1412-92 for corrosion resistance and material content. The vent system will contain no PVC or solvents used for assembly. Vent may be constructed using rigid or flexible pipe as required. Vents will be manufactured by Scientific Plastics, Inc. of Kansas City, KS, USA.

403100-VENT KIT

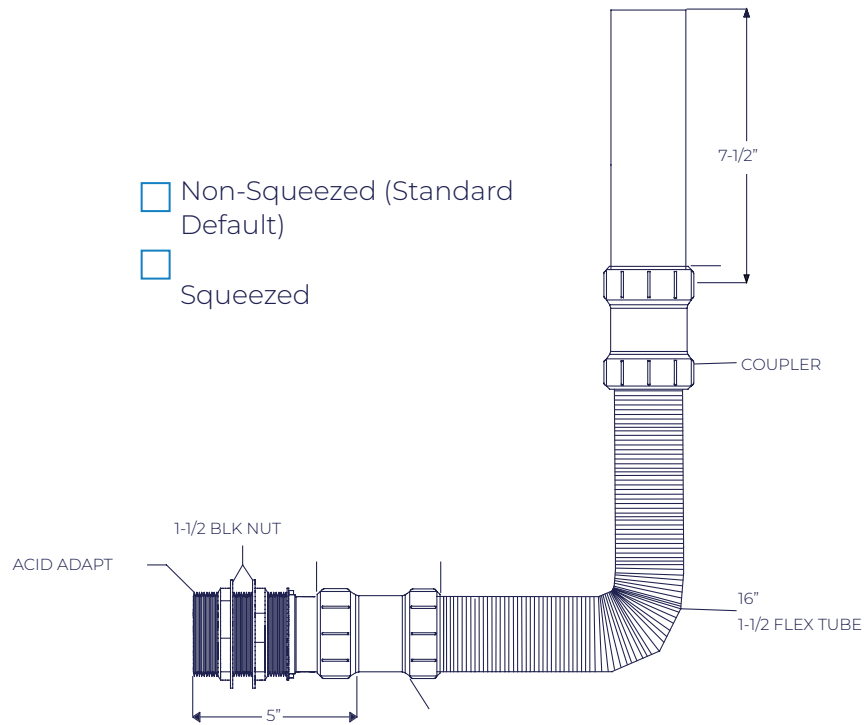

403100-VENT KIT-L

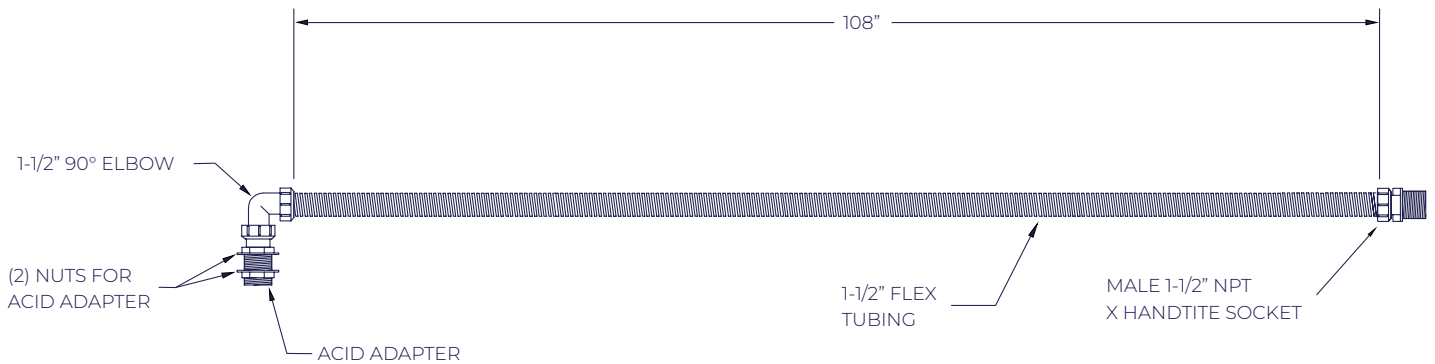

Base Cabinets - Flammables

Flammable storage cabinets are reinforced steel with a hi-tech performance polymer alloy coating, which provides 100% coverage against corrosion. Cabinets are available in 18" and 22" depths. All cabinets have 3 point locking systems.

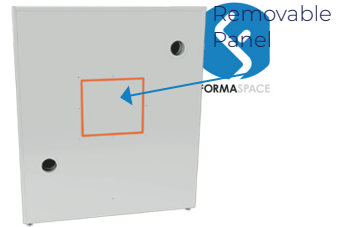

Example: **SASB3518-22R** — Right Hinged
 Height Depth
 | |
 +-----+
 | |
 +-----+
 Width

Flammables Storage Cabinets



SFSB2924-18



SFSB2930-18

Width	Sitting Height	ADA Height	Standing Height
24"	SFSB2924-18	SFSB3224-18	SFSB3524-18
30"	SFSB2930-18	SFSB3230-18	SFSB3530-18
36"	SFSB2936-18	SFSB3236-18	SFSB3536-18
42"	SFSB2942-18	SFSB3242-18	SFSB3542-18
48"	SFSB2948-18	SFSB3248-18	SFSB3548-18

Width	Sitting Height	ADA Height	Standing Height
24"	SFSB2924-22	SFSB3224-22	SFSB3524-22
30"	SFSB2930-22	SFSB3230-22	SFSB3530-22
36"	SFSB2936-22	SFSB3236-22	SFSB3536-22
42"	SFSB2942-22	SFSB3242-22	SFSB3542-22
48"	SFSB2948-22	SFSB3248-22	SFSB3548-22

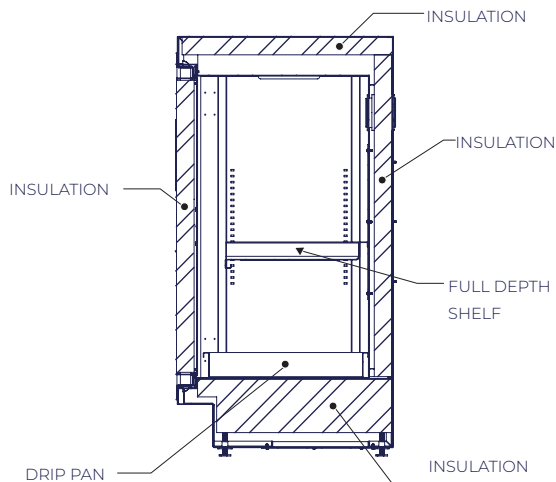

18-3/8" ACTUAL DEPTH

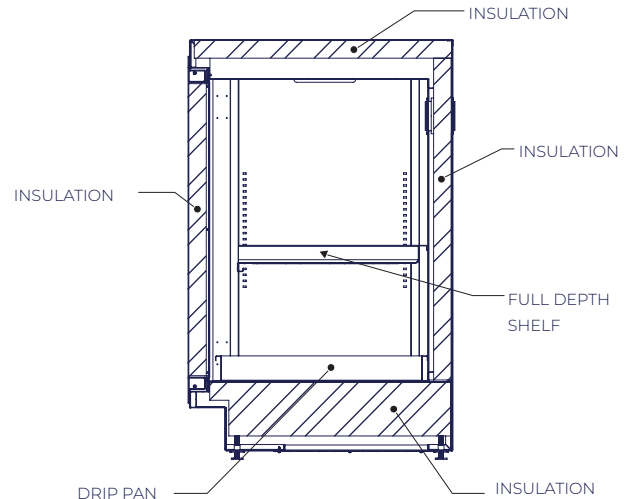

22 3/8" ACTUAL DEPTH

Base Cabinets - Flammables

Flammable storage cabinets are reinforced steel with a hi-tech performance polymer alloy coating, which provides 100% coverage against corrosion. Cabinets are available in 18" and 22" depths. All cabinets have 3 point locking systems.

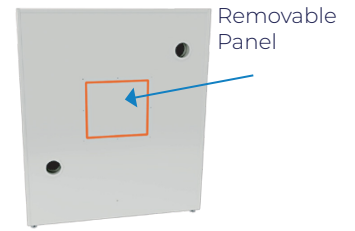
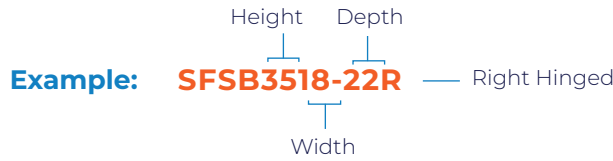

Flammables Storage Cabinets

24" Wide (1 DOOR)

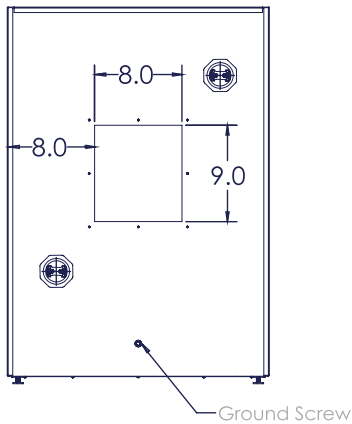

30" Wide (2 DOOR)

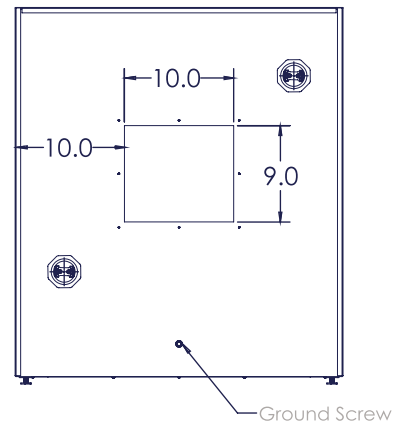

SFSBM3530-18

Mobile cabinets are available. Please contact your workbenches.com representative.

Width	Sitting Height	ADA Height	Standing Height	Width	Sitting Height	ADA Height	Standing Height
24"	SFSBM2924-18	SFSBM3224-18	SFSBM3524-18	24"	SFSBM2924-22	SFSBM3224-22	SFSBM3524-22
30"	SFSBM2930-18	SFSBM3230-18	SFSBM3530-18	30"	SFSBM2930-22	SFSBM3230-22	SFSBM3530-22
36"	SFSBM2936-18	SFSBM3236-18	SFSBM3536-18	36"	SFSBM2936-22	SFSBM3236-22	SFSBM3536-22
42"	SFSBM2942-18	SFSBM3242-18	SFSBM3542-18	42"	SFSBM2942-22	SFSBM3242-22	SFSBM3542-22
48"	SFSBM2948-18	SFSBM3248-18	SFSBM3548-18	48"	SFSBM2948-22	SFSBM3248-22	SFSBM3548-22

Flammables storage cabinets are certified to meet NFPA 45 and are UL listed. Cabinets are available in 18" and 22" depths. For 22" depth, add suffix "-22" to the part number. For synchronized self-closing doors add "-SCC" to the part number.

*Cabinets with self-closing doors are constructed to the UL1275 standards, but cannot have a UL label

Mobile Cabinets



All workbenches.com cabinets are available in a mobile version including low profile (27.18" high), sitting height (28.75" high), ADA height (31.75" high), and standing height (34.75" high). They come standard with a finished back and optional finished top. To specify a mobile cabinet use the prefix "M" to the base cabinet model number (example: SMB2724-110). They come standard with a 3" wheel caster. There is no height changes to the cabinets when replaced toe kicks with casters. 2" casters are available by adding the suffix "-2" to the part number. Cabinet depth with finished back is 22.812". All mobile cabinets with drawers come standard with a tip resistant counter weight.

Tops: Please add the suffix "T" for steel, "E" for epoxy, "P" for phenolic. All tops are 3/4" thick and with a 7/8" overhang on front only. No top overhang for Overlay Mobile Cabinets (example SMB2724-110L-T)

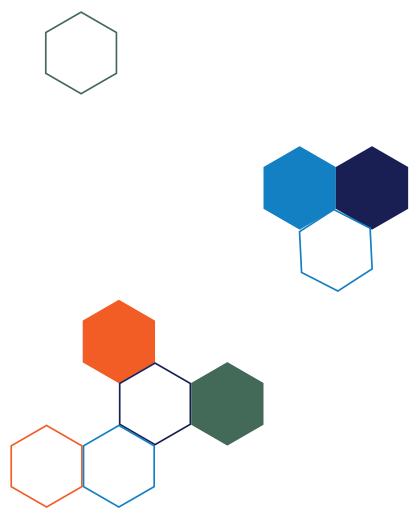

Mobile Cabinets

Standing height mobile cabinets are 34.75" high and 22.873" deep. Units are available in various widths. Each example below is available in the standard four heights shown on the left. Door units feature a single shelf as standard for standing height cabinets. All open units have 2 shelves. Additional shelves are available. Specify left- or right-hinged doors using the suffix "L" or "R". If locks are required use the suffix "LK".



22.873"

Door & Drawer Cabinets



Width	Item Number
12"	SMB3512-100R
15"	SMB3515-100R
18"	SMB3518-100R
21"	SMB3521-100R
24"	SMB3524-100R

12"	SMB3512-100L
15"	SMB3515-100L
18"	SMB3518-100L
21"	SMB3521-100L
24"	SMB3524-100L



Width	Item Number
30"	SMB3530-200
36"	SMB3536-200
42"	SMB3542-200
48"	SMB3548-200



Width	Left & Right Hinged
12"	SMB3512-110L
15"	SMB3515-110L
18"	SMB3518-110L
21"	SMB3521-110L
24"	SMB3524-110L

12"	SMB3512-110R
15"	SMB3515-110R
18"	SMB3518-110R
21"	SMB3521-110R
24"	SMB3524-110R



Width	Item Number
30"	SMB3530-220
36"	SMB3536-220
42"	SMB3542-220
48"	SMB3548-220



Width	Item Number
30"	SMB3530-210
36"	SMB3536-210
42"	SMB3542-210
48"	SMB3548-210

Note: L(left) or R(right) refers to door hinge side.

Overlay Cabinets



All workbenches.com base cabinets are available in an overlay version including low profile (27.18" high), sitting height (28.75" high), ADA height (31.75" high), and standing height (34.75" high). To specify an overlay cabinet, use the prefix "O" to the base cabinet model number (example: SOB2724-110). Overlay cabinets are also available in mobile and suspended variations.

Tops: Please add the suffix "T" for steel, "E" for epoxy, "P" for phenolic. All tops are 3/4" thick and with a 7/8" overhang on front only.
(example SOB2724-110L-T)



Overlay Cabinets

Standing height overlay base cabinets are 34.75" high and 23.248" deep (Including doors and drawers depth). Units are available in various widths. Each example below is available in the standard four heights shown on the left. Door units feature a single shelf as standard. All open units have 2 shelves. Additional shelves are available. Specify left- or right-hinged doors using the suffix "L" or "R". If locks are required use the suffix "LK".

34.75"

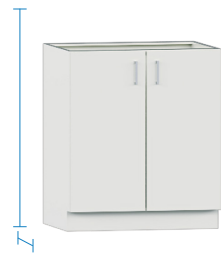

23.248"

Door & Drawer Cabinets



Width	Item Number
12"	SOB3512-100R
15"	SOB3515-100R
18"	SOB3518-100R
21"	SOB3521-100R
24"	SOB3524-100R
12"	SOB3512-100L
15"	SOB3515-100L
18"	SOB3518-100L
21"	SOB3521-100L
24"	SOB3524-100L



Width	Item Number
30"	SOB3530-200
36"	SOB3536-200
42"	SOB3542-200
48"	SOB3548-200



Width	Left & Right Hinged
12"	SOB3512-110L
15"	SOB3515-110L
18"	SOB3518-110L
21"	SOB3521-110L
24"	SOB3524-110L
12"	SOB3512-110R
15"	SOB3515-110R
18"	SOB3518-110R
21"	SOB3521-110R
24"	SOB3524-110R



Width	Item Number
30"	SOB3530-220
36"	SOB3536-220
42"	SOB3542-220
48"	SOB3548-220



Width	Item Number
30"	SOB3530-210
36"	SOB3536-210
42"	SOB3542-210
48"	SOB3548-210

Note: L(left) or R(right) refers to door hinge side.

Tall Cabinets



Tall cabinets are 84" high and available in 16", 18", 21" and 24" deep by using the two digit suffix. Suffix is not needed when selecting 16" deep. Units are available in various widths as shown. Door units feature five shelves as standard. Additional shelves are available. Specify left- or right-hinged doors using the suffix "L" or "R" after the two digit depth number. If locks are required use the suffix "LK".

Wardrobe cabinets are available by adding the suffix "W" to any of the standard part numbers. They will include one hanging bar in lieu of shelves. For pull out shelves add the suffix "PS".

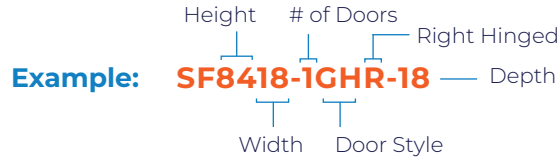
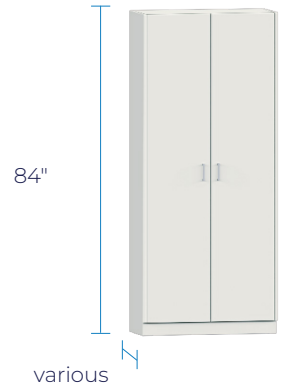

Open Cabinets



Width	Item Number
18"	SF8418-000
24"	SF8424-000

Up to 24" wide



Width	Item Number
30"	SF8430-000
36"	SF8436-000
42"	SF8442-000
48"	SF8448-000

30" and wider

Door Cabinets



Width	Left & Right Hinged
18"	SF8418-1SHL
24"	SF8424-1SHL
18"	SF8418-1SHR
24"	SF8424-1SHR

Right-hinged door shown



Width	Item Number
30"	SF8430-2SH
36"	SF8436-2SH
42"	SF8442-2SH
48"	SF8448-2SH



Width	Item Number
30"	SF8430-2SS
36"	SF8436-2SS
42"	SF8442-2SS
48"	SF8448-2SS

(this unit has sliding doors)



Width	Item Number
30"	SF8430-4SH
36"	SF8436-4SH
42"	SF8442-4SH
48"	SF8448-4SH

Tall Cabinets

Tall cabinets are 84" high and available in 16", 18", 21" and 24" deep by using the two digit suffix. Suffix is not needed when selecting 16" deep. Units are available in various widths as shown. Door units feature five shelves as standard. Additional shelves are available. Specify left- or right-hinged doors using the suffix "L" or "R" after the two digit depth number. If locks are required use the suffix "LK".

Wardrobe cabinets are available by adding the suffix "W" to any of the standard part numbers. They will include one hanging bar in lieu of shelves. For pull out shelves add the suffix "PS".

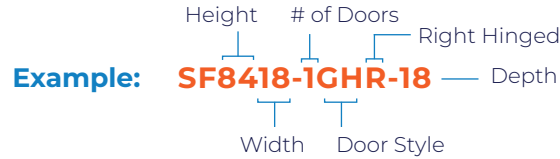
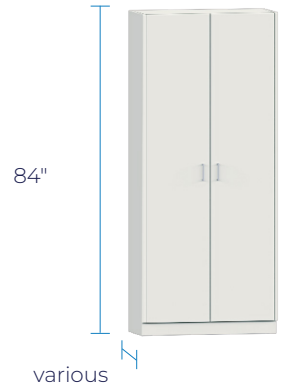

Door Cabinets



Width	Left & Right Hinged
18"	SF8418-1GHL
24"	SF8424-1GHL
18"	SF8418-1GHR
24"	SF8424-1GHR



Width	Item Number
30"	SF8430-2GH
36"	SF8436-2GH
42"	SF8442-2GH
48"	SF8448-2GH

Right-hinged door shown



Width	Item Number
30"	SF8430-2GSF
36"	SF8436-2GSF
42"	SF8442-2GSF
48"	SF8448-2GSF

(this unit has sliding doors)



Width	Item Number
30"	SF8430-4GH
36"	SF8436-4GH
42"	SF8442-4GH
48"	SF8448-4GH



Width	Item Number
30"	SF8430-2GH2SH
36"	SF8436-2GH2SH
42"	SF8442-2GH2SH
48"	SF8448-2GH2SH



Pull out shelves are available upon request.

Wall Cabinets - 24" Height



Wall cabinets are available in 24", 30", 36" and 48" heights and come standard with a 13" depth. For 16" deep cabinets, use the suffix "16". Units are available in various widths as shown. They feature one shelf as standard for 24" units. Specify left- or right-hinged doors using the suffix "L" or "R" after the two digit depth number. If locks are required, use the suffix "LK".

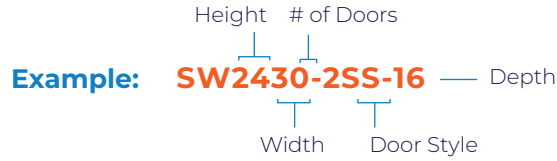
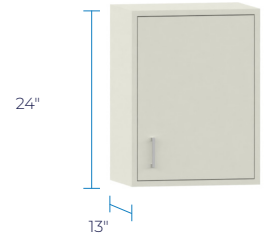

Open Cabinets



Up to 24" wide

Width	Item Number
18"	SW2418-000
24"	SW2424-000



30" and wider

Width	Item Number
30"	SW2430-000
36"	SW2436-000
42"	SW2442-000
48"	SW2448-000

Steel-Hinged Door Cabinets



Right-hinged door shown

Width	Left & Right Hinged
18"	SW2418-1SHL
24"	SW2424-1SHL
18"	SW2418-1SHR
24"	SW2424-1SHR



30" and wider

Width	Item Number
30"	SW2430-2SH
36"	SW2436-2SH
42"	SW2442-2SH
48"	SW2448-2SH

Steel Sliding Door Cabinets



30" and wider

Width	Item Number
30"	SW2430-2SS
36"	SW2436-2SS
42"	SW2442-2SS
48"	SW2448-2SS

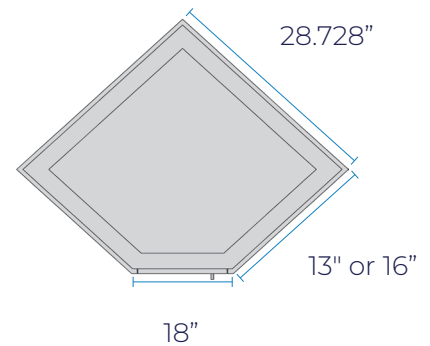

Corner Cabinets



Item Number
SWC2418-000



Right-hinged door shown

Left Hinged	Right Hinged
SWC2418-1SHL	SWC2418-1SHR



Left Hinged	Right Hinged
SWC2418-1GHL	SWC2418-1GHR

*Lazy Susan Add-On Suffix "LS"

Wall Cabinets - 24" Height

Wall cabinets are available in 24", 30", 36" and 48" heights and come standard with a 13" depth. For 16" deep cabinets, use the suffix "16". Units are available in various widths as shown. They feature one shelf as standard for 24" units. Specify left- or right-hinged doors using the suffix "L" or "R" after the two digit depth number. If locks are required, use the suffix "LK".

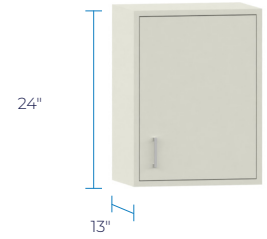
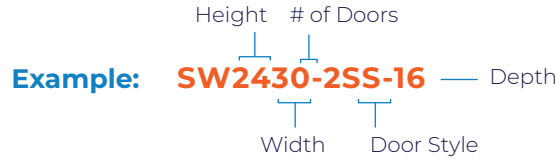

Framed Glass Hinged Door Cabinets



Right-hinged door shown

Width	Left & Right Hinged
18"	SW2418-1GHL
24"	SW2424-1GHL
18"	SW2418-1GHR
24"	SW2424-1GHR



30" and wider

Width	Item Number
30"	SW2430-2GH
36"	SW2436-2GH
42"	SW2442-2GH
48"	SW2448-2GH

Framed Glass Sliding Door Cabinets



30" and wider

Width	Item Number
30"	SW2430-2GSF
36"	SW2436-2GSF
42"	SW2442-2GSF
48"	SW2448-2GSF

Glass Sliding Door Cabinets



30" and wider

Width	Item Number
30"	SW2430-2GS
36"	SW2436-2GS
42"	SW2442-2GS
48"	SW2448-2GS

Wall Cabinets - 30" Height



Wall cabinets are available in 24", 30", 36" and 48" heights and come standard with a 13" depth. For 16" deep cabinets, use the suffix "16". Units are available in various widths as shown. They feature two shelves as standard for 30" units. Specify left- or right-hinged doors using the suffix "L" or "R" after the two digit depth number. If locks are required, use the suffix "LK".

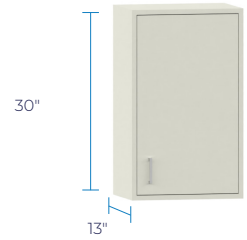

Example: **SW3030-2SS-16**

Height: 30" | # of Doors: 2 | Door Style: SS | Depth: 16" | Width: 30"

Open Cabinets



Up to 24" wide

Width	Item Number
18"	SW3018-000
24"	SW3024-000



30" and wider

Width	Item Number
30"	SW3030-000
36"	SW3036-000
42"	SW3042-000
48"	SW3048-000

Steel-Hinged Door Cabinets



Right-hinged door shown

Width	Left & Right Hinged
18"	SW3018-1SHL
24"	SW3024-1SHL
18"	SW3018-1SHR
24"	SW3024-1SHR



30" and wider

Width	Item Number
30"	SW3030-2SH
36"	SW3036-2SH
42"	SW3042-2SH
48"	SW3048-2SH

Steel Sliding Door Cabinets



30" and wider

Width	Item Number
30"	SW3030-2SS
36"	SW3036-2SS
42"	SW3042-2SS
48"	SW3048-2SS

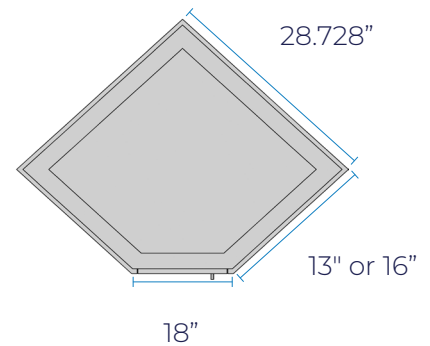

Corner Cabinets

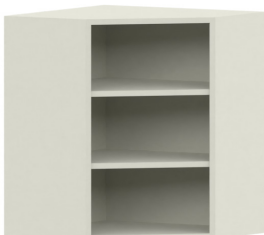

Item Number

SWC3018-000



Right-hinged door shown

*Lazy Susan Add-On Suffix "LS"

Left Hinged

SWC3018-1SHL

Right Hinged

SWC3018-1SHR



Left Hinged

SWC3018-1GHL

Right Hinged

SWC3018-1GHR

Wall Cabinets - 30" Height

Wall cabinets are available in 24", 30", 36" and 48" heights and come standard with a 13" depth. For 16" deep cabinets, use the suffix "16". Units are available in various widths as shown. They feature two shelves as standard for 30" units. Specify left- or right-hinged doors using the suffix "L" or "R" after the two digit depth number. If locks are required, use the suffix "LK".

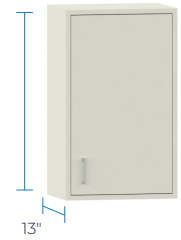

Framed Glass Hinged Door Cabinets



Right-hinged door shown

Width	Left & Right Hinged
18"	SW3018-1GHL
24"	SW3024-1GHL
18"	SW3018-1GHR
24"	SW3024-1GHR



30" and wider

Width	Item Number
30"	SW3030-2GH
36"	SW3036-2GH
42"	SW3042-2GH
48"	SW3048-2GH

Framed Glass Sliding Door Cabinets



30" and wider

Width	Item Number
30"	SW3030-2GSF
36"	SW3036-2GSF
42"	SW3042-2GSF
48"	SW3048-2GSF

Glass Sliding Door Cabinets



30" and wider

Width	Item Number
30"	SW3030-2GS
36"	SW3036-2GS
42"	SW3042-2GS
48"	SW3048-2GS

Wall Cabinets - 36" Height



Wall cabinets are available in 24", 30", 36" and 48" heights and come standard with a 13" depth. For 16" deep cabinets, use the suffix "16". Units are available in various widths as shown. They feature two shelves as standard for 36" units. Specify left- or right-hinged doors using the suffix "L" or "R" after the two digit depth number. If locks are required, use the suffix "LK".

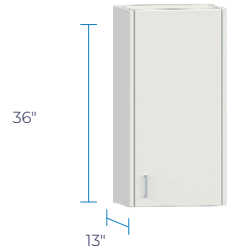

Example: **SW3030-2SS-16**

Height: 30", # of Doors: 2, Width: 30", Door Style: SS, Depth: 16"

Open Cabinets



Up to 24" wide

Width	Item Number
18"	SW3618-000
24"	SW3624-000



30" and wider

Width	Item Number
30"	SW3630-000
36"	SW3636-000
42"	SW3642-000
48"	SW3648-000

Steel-Hinged Door Cabinets



Right-hinged door shown

Width	Left & Right Hinged
18"	SW3618-1SHL
24"	SW3624-1SHL
18"	SW3618-1SHR
24"	SW3624-1SHR



30" and wider

Width	Item Number
30"	SW3630-2SH
36"	SW3636-2SH
42"	SW3642-2SH
48"	SW3648-2SH

Steel Sliding Door Cabinets



30" and wider

Width	Item Number
30"	SW3630-2SS
36"	SW3636-2SS
42"	SW3642-2SS
48"	SW3648-2SS

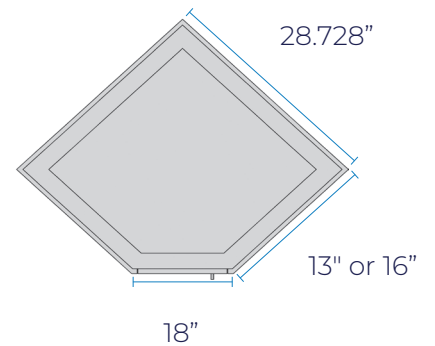

Corner Cabinets



Item Number

SWC3618-000



Right-hinged door shown

*Lazy Susan Add-On Suffix "LS"

Left Hinged

SWC3618-1SHL

Right Hinged

SWC3618-1SHR



Left Hinged

SWC3618-1GHL

Right Hinged

SWC3618-1GHR

Wall Cabinets - 36" Height

Wall cabinets are available in 24", 30", 36" and 48" heights and come standard with a 13" depth. For 16" deep cabinets, use the suffix "16". Units are available in various widths as shown. They feature two shelves as standard for 36" units. Specify left- or right-hinged doors using the suffix "L" or "R" after the two digit depth number. If locks are required, use the suffix "LK".

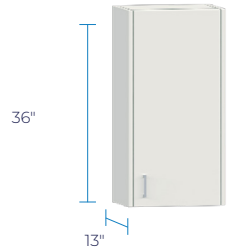

Framed Glass Hinged Door Cabinets



Right-hinged door shown

Width	Left & Right Hinged
18"	SW3618-1GHL
24"	SW3624-1GHL
18"	SW3618-1GHR
24"	SW3624-1GHR



30" and wider

Width	Item Number
30"	SW3630-2GH
36"	SW3636-2GH
42"	SW3642-2GH
48"	SW3648-2GH

Framed Glass Sliding Door Cabinets



30" and wider

Width	Item Number
30"	SW3630-2GSF
36"	SW3636-2GSF
42"	SW3642-2GSF
48"	SW3648-2GSF

Glass Sliding Door Cabinets



30" and wider

Width	Item Number
30"	SW3630-2GS
36"	SW3636-2GS
42"	SW3642-2GS
48"	SW3648-2GS

Wall Cabinets - 48" Height



Wall cabinets are available in 24", 30", 36" and 48" heights and come standard with a 13" depth. For 16" deep cabinets, use the suffix "16". Units are available in various widths as shown. They feature three shelves as standard for 48" units. Specify left- or right-hinged doors using the suffix "L" or "R" after the two digit depth number. If locks are required, use the suffix "LK".

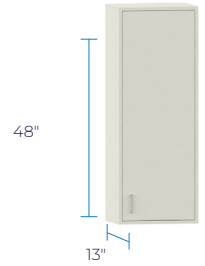

Example: **SW4830-2SS-16**

Height: 48" (from SW4830)
 # of Doors: 2 (from -2SS)
 Width: 30" (from SW4830)
 Door Style: SS (from -2SS)
 Depth: 16" (from -16)

Open Cabinets



Up to 24" wide

Width	Item Number
18"	SW4818-000
24"	SW4824-000

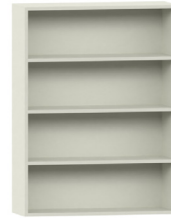

30" and wider

Width	Item Number
30"	SW4830-000
36"	SW4836-000
42"	SW4842-000
48"	SW4848-000

Steel-Hinged Door Cabinets



Right-hinged door shown

Width	Left & Right Hinged
18"	SW4818-1SHL
24"	SW4824-1SHL
18"	SW4818-1SHR
24"	SW4818-1SHR



30" and wider

Width	Item Number
30"	SW4830-2SH
36"	SW4836-2SH
42"	SW4842-2SH
48"	SW4848-2SH

Steel Sliding Door Cabinets



30" and wider

Width	Item Number
30"	SW4830-2SS
36"	SW4836-2SS
42"	SW4842-2SS
48"	SW4848-2SS

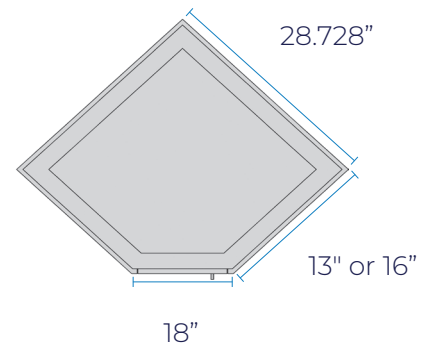

Corner Cabinets



Item Number

SWC4818-000



Right-hinged door shown

*Lazy Susan Add-On Suffix "LS"

Left Hinged

SWC4818-1SHL

Right Hinged

SWC3618-1SHR



Left Hinged

SWC4818-1GHL

Right Hinged

SWC4818-1GHR

Wall Cabinets - 48" Height



Wall cabinets are available in 24", 30", 36" and 48" heights and come standard with a 13" depth. For 16" deep cabinets, use the suffix "16". Units are available in various widths as shown. They feature three shelves as standard for 48" units. Specify left- or right-hinged doors using the suffix "L" or "R" after the two digit depth number. If locks are required, use the suffix "LK".

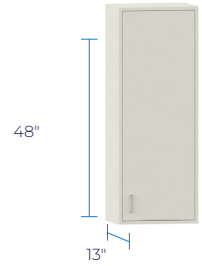

Framed Glass Hinged Door Cabinets



Width	Left & Right Hinged
18"	SW4818-1GHL
24"	SW4824-1GHL
18"	SW4818-1GHR
24"	SW4824-1GHR

Right-hinged door shown

Framed Glass Sliding Door Cabinets



Width	Item Number
30"	SW4830-2GH
36"	SW4836-2GH
42"	SW4842-2GH
48"	SW4848-2GH

30" and wider

Framed Glass Sliding Door Cabinets



Width	Item Number
30"	SW4830-2GSF
36"	SW4836-2GSF
42"	SW4842-2GSF
48"	SW4848-2GSF

30" and wider

Glass Sliding Door Cabinets

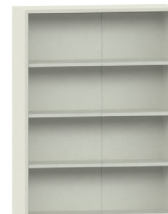

Width	Item Number
30"	SW4830-2GS
36"	SW4836-2GS
42"	SW4842-2GS
48"	SW4848-2GS

30" and wider

Filler Panels



Base cabinet filler panels are available in 29", 32" and 35" high. Floor case filler panels are available in 84" high. They are all available in any width required by entering the dimension in lieu of the "XX" in the part number. Note: workbenches.com base cabinets are 22.375" deep. (Example: SLF35-6.625)

C-Filler



Item Number	Item Number	Item Number
SCF29-XX	SCF32-XX	SCF35-XX

C-Front Filler



Item Number	Item Number	Item Number
SFFC29-XX	SFFC32-XX	SFFC35-XX

L-Filler



Item Number	Item Number	Item Number
SLF29-XX	SLF32-XX	SLF35-XX

L-Front Filler



Item Number	Item Number	Item Number
SFFL29-XX	SFFL32-XX	SFFL35-XX

Filler Panels

Base cabinet filler panels are available in 29¹/₈" , 32¹/₈" and 35¹/₈" high. Floor case filler panels are available in 84" high. They are all available in any width required by entering the dimension in lieu of the "XX" in the part number. Note: workbenches.com base cabinets are 22.375" deep. (Example: SLF35-6.625)

Corner Filler



Item Number	Item Number	Item Number
SICF29-XX	SICF32-XX	SICF35-XX

Floor Case Filler



Item Number
SFFL84-XX

Toe Space Filler



Item Number
STSF-XX

Wall Case Front Filler



Item Number	Item Number	Item Number	Item Number
SWCFF24-XX	SWCFF30-XX	SWCFF36-XX	SWCFF48-XX

Wall cabinet front filler panels are available in 24", 30", 36" and 48" high. They are all available in any width required by entering the dimension in lieu of the "XX" in the part number. To specify the depth use the suffix "-13" or "-16".

Wall Case Corner Filler

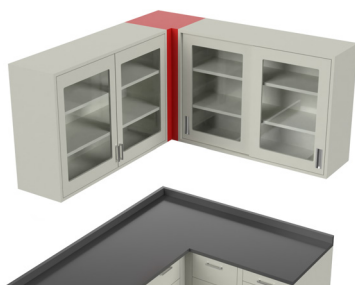













Item Number	Item Number	Item Number	Item Number
SWCCF24	SWCCF30	SWCCF36	SWCCF48

Finishes

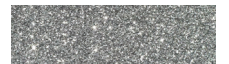

Powder Coated Steel Frames & Fronts

Powder coating is a durable, cost-effective, and environmentally friendly finishing solution that outperforms traditional paint. At workbenches.com, we offer high-quality powder coating services designed for industrial and professional applications. Our finishes provide superior resistance to wear, chemicals, and corrosion - ensuring long-lasting performance for you workspace.

					
Powder Coated Steel: Almond (BG-01)	Black Semi Gloss (BK-266)	Black Texture (BK-59)	Blue Light (RAL5012)	Blue Sapphire (RAL5003)	Blue Traffic (RAL5017)
					
Gray Dark (RAL 7045)	Gray Light (RAL 7035)	Red (RD-01)	Gray Steel Pearlescent (T028-GR02)	Silver Sparkle (049/90450)	White Semi Gloss Textured (WH120)
					
White Gloss Smooth (WH1)					

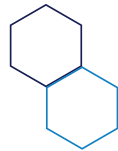
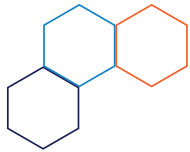



📞 800.251.1505

✉️ hello@formaspace.com

🌐 formaspace.com